

REVISIONS				
REV	ECN #	DESCRIPTION	REV. BY/DATE	APR. BY
A	-----	INITIAL RELEASE	07/2000	

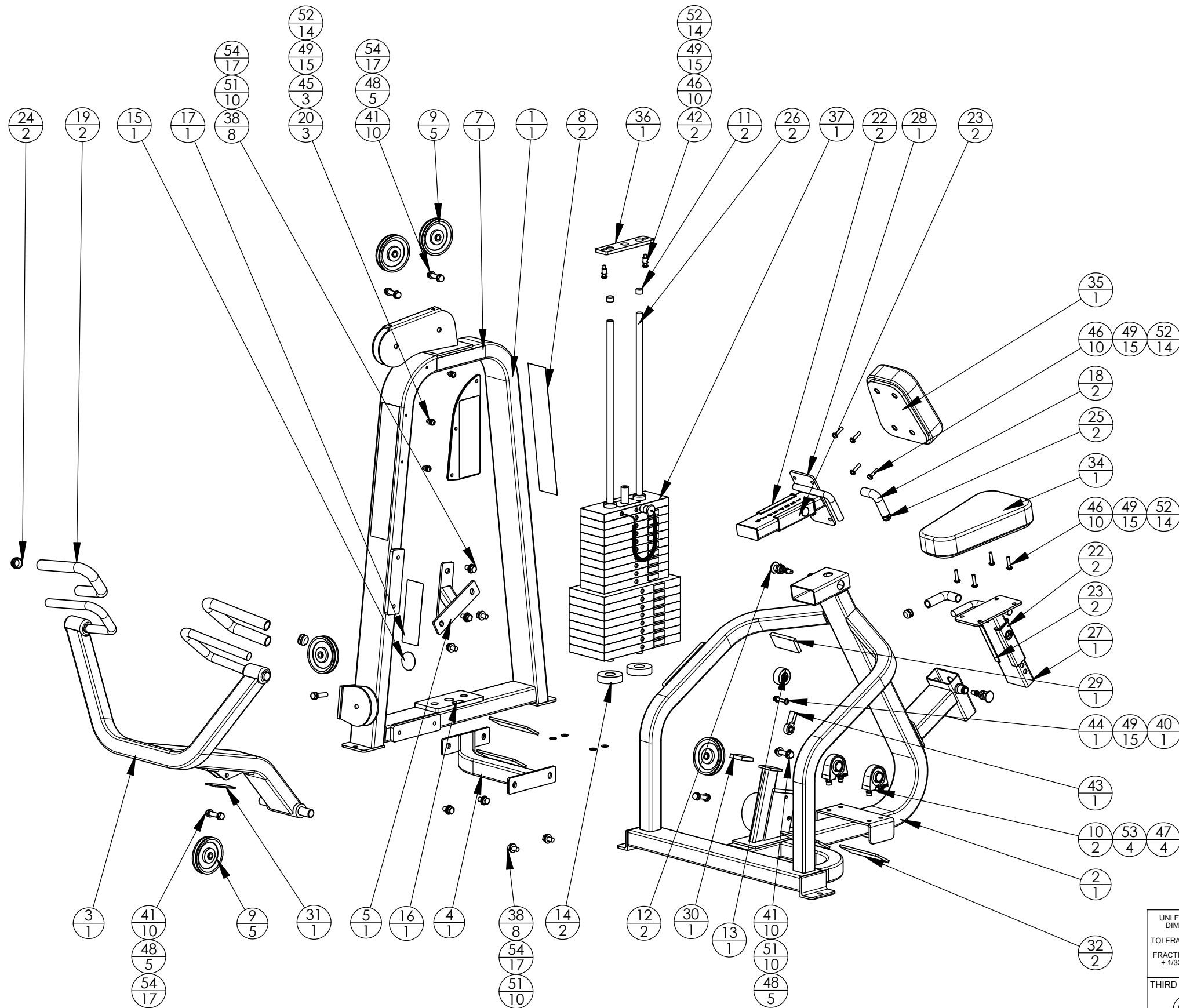

ITEM NO.	QTY.	PART NO.	DESCRIPTION
1	1	310-SA-1	310 MAIN FRAME ASSY
2	1	310-SA-2	310 SEAT FRAME ASSEMBLY
3	1	310-SA-3	310 HANDLE ASSEMBLY
4	1	310-SA-4	310 LOWER STRUT
5	1	310-SA-6	310 UPPER STRUT
6	1	AC0310B	LABEL, INSTRUCTION, "SEATED ROW 310"
7	1	AC1001	LABEL, "ICARIAN", 1 1/2 x 8 1/8
8	2	AC1002	LABEL, "ICARIAN", 3 1/2 x 21 1/2
9	5	AC1009	PULLEY, 4 1/2" DIA x 1/2" ID
10	2	AC1026	PILLOW BLOCK BEARING 2 BOLT, TAPPED
11	2	AC1040	CAP, GUIDE ROD, DIA. 3/4
12	2	AC1051-MS	SNAP PIN, SMALL M-PULL
13	1	AC1110	WHEEL, BLACK, DIA. 2
14	2	AC1148	WEIGHT STACK BUMPER
15	1	AC1161	LABEL, ROUND, "MADE IN USA"
16	1	AC1164	LABEL, F.P.I. SERIAL NUMBER
17	1	AC1183	LABEL, "WARNING, SERIOUS INJURY..."
18	2	AC1225-6	RUBBERGRIP, DIA 3/4 x (5)
19	2	AC1225-21	RUBBERGRIP, DIA 1 x (20)
20	3	AC1228	SPACER, ALU, 21/64 ID x 5/8 OD x (1/4)
21	1	AC1230	INSTRUCTION PLACARD, 1/4" TEXTURED ABS PLASTIC
22	2	AC1236-H	PLASTIC GLIDE WITH HOLE
23	2	AC1236-P	PLASTIC GLIDE WITH PLUG
24	2	AC218	HANDLE END CAP W/SET SCREWS, DIA 1"
25	2	AC220	HANDLE END CAP W/SET SCREWS, DIA 3/4"
26	2	CH1212	GUIDE ROD, 3/4 x 42 5/8 (#4)
27	1	CH4002	ASSY. SEAT ADJ, 20 DEG, 8 HOLE
28	1	CH4003	ASSY. SEAT ADJUSTMENT, ANGLED, 8 HOLE
29	1	CP0008	CUT PIECE CREPE 7/16 x 2 x (4)
30	1	CP1037	CUT PIECE, CREPE, 7/16 x 2 x 2
31	1	CP1078	CUT PIECE, ABS BLACK, 1/8 x 1 3/4 x 3 1/2
32	2	CP1189	CREPE, 1/4 x 2 1/2 x 6 1/2
33	1	GP-310-127-125	CABLE ASSY, GP-310-127-125
34	1	PD1207	PAD, SEAT, 9 x 5 x (14 1/2), 4 HOLES
35	1	PD1209	PAD, 6 1/4 x 9 x 10, 4 HOLES
36	1	PF1016	STEEL BAR FLAT CR/HR, 3/8 x 2 x (8 1/4)
37	1	WS2600	WEIGHT STACK, 18 PLATE, 260 LBS.
38	8	FA1011	BOLT, HEX HEAD, BLK, 1/2-13 x 1
39	1	FA1013	BOLT, HEX HEAD, 1/2-13 x 2
40	1	FA1034	NUT, HEX, ACORN, 5/16-18
41	10	FA1035	NUT, HEX, ACORN, 1/2-13
42	2	FA1055	NUT, INSERT, 5/16-18
43	1	FA1064	ROD END, FEMALE, STEEL, ZINC, CAD, R.H.T.
44	1	FA1069	BOLT, BUTTON HEAD, 5/16-18 x 2
45	3	FA1071	BOLT, BUTTON HEAD, 5/16-18 x 1
46	10	FA1072	BOLT, BUTTON HEAD, 5/16-18 x 1 1/2
47	4	FA1078	BOLT, SOCKET HEAD, 3/8-16 x 1
48	5	FA1101	STUD, 1/2-13 x 2 1/2
49	15	FA1106	WASHER, FLAT, 5/16 ID x 11/16 OD
50	4	FA1107	WASHER, FLAT, 3/8 ID x 13/16 OD
51	10	FA1109	WASHER, FLAT, 1/2 ID x 1 1/16 OD
52	14	FA1116	WASHER, SPLIT, 5/16 ID
53	4	FA1117	WASHER, SPLIT, 3/8 ID
54	17	FA1119	WASHER, SPLIT, 1/2 ID

WEIGHT: 530 LBS.

UNLESS OTHERWISE SPECIFIED DIMENSIONS ARE IN INCHES

TOLERANCES ARE:

FRACTIONS	DECIMALS	ANGLES
± 1/32	.XX ± .01 .XXX ± .005	± 1°

THIRD ANGLE PROJECTION

DO NOT SCALE DRAWING

**ICARIAN** FITNESS PRODUCTS INTERNATIONAL  
ICARIAN FLITE ABENCH JADE STRETCH CENTER  
12660 BRANFORD ST. SUN VALLEY, CA. 91352

APPROVALS	DATE	TITLE	SCALE
DESIGNED BY VLE	03/00	SEATED ROW	1:13
MODELED BY VLE	03/00		
DRAWN BY VLE	07/00	SIZE B	SHEET 1 OF 1
APPROVED BY		DWG NO. 310-EXP	REV A

**310 Seated Row**

<b>Part Number</b>	<b>Description</b>	<b>Bubble Number</b>
CW310SA1-211	ASSY,FRAME,MAIN,310,SKY WHITE	1.01
CW310SA1-221	ASSY,FRAME,MAIN,310,BLACK	1.02
CW310SA1-231	ASSY,FRAME,MAIN,310,RED	1.03
CW310SA1-241	ASSY,FRAME,MAIN,310,PLATINUM SPRKLE	1.04
CW310SA1-251	ASSY,FRAME,MAIN,310,SILVER	1.05
CW310SA1-261	ASSY,FRAME,MAIN,310,BLUE	1.06
CW310SA1-271	ASSY,FRAME,MAIN,310,CHARCOAL	1.07
CW310SA1-281	ASSY,FRAME,MAIN,310,CATHEDRAL GRAY	1.08
CW310SA1-291	ASSY,FRAME,MAIN,310,SILVER VIEN	1.09
CW310SA1-311	ASSY,FRAME,MAIN,310,STONE HG	1.11
CW310SA1-321	ASSY,FRAME,MAIN,310,TITANIUM HG	1.12
CW310SA1-331	ASSY,FRAME,MAIN,310,WHITE GLOSS	1.13
CW310SA1-341	ASSY,FRAME,MAIN,310,BLACK ONYX	1.14
CW310SA1-351	ASSY,FRAME,MAIN,310,LIGHT BRONZE	1.15
CW310SA1-361	ASSY,FRAME,MAIN,310,SAPPHIRE BLUE	1.16
CW310SA2-211	ASSY,SEAT FRAME,310,SKY WHITE	2.01
CW310SA2-212	ASSY,SEAT FRAME,310,SKY WHITE	2.01
CW310SA2-221	ASSY,SEAT FRAME,310,BLACK	2.02
CW310SA2-222	ASSY,SEAT FRAME,310,BLACK	2.02
CW310SA2-231	ASSY,SEAT FRAME,310,RED	2.03
CW310SA2-241	ASSY,SEAT FRAME,310,PLATINUM SPARKL	2.04
CW310SA2-251	ASSY,SEAT FRAME,310,SILVER	2.05
CW310SA2-261	ASSY,SEAT FRAME,310,BLUE	2.06
CW310SA2-271	ASSY,SEAT FRAME,310,CHARCOAL	2.07
CW310SA2-281	ASSY,SEAT FRAME,310,CATHEDRAL GRAY	2.08
CW310SA2-291	ASSY,SEAT FRAME,310,SILVER VEIN	2.09
CW310SA2-311	ASSY,SEAT FRAME,310,STONE HG	2.11
CW310SA2-312	ASSY,SEAT FRAME,310,STONE HG	2.11
CW310SA2-321	ASSY,SEAT FRAME,310,TITANIUM HG	2.12
CW310SA2-322	ASSY,SEAT FRAME,310,TITANIUM HG	2.12
CW310SA2-331	ASSY,SEAT FRAME,310,WHITE GLOSS	2.13
CW310SA2-341	ASSY,SEAT FRAME,310,BLACK ONYX	2.14
CW310SA2-351	ASSY,SEAT FRAME,310,LIGHT BRONZE	2.15
CW310SA2-352	ASSY,SEAT FRAME,310,LIGHT BRONZE	2.15
CW310SA2-361	ASSY,SEAT FRAME,310,SAPPHIRE BLUE	2.16
CW310SA2-362	ASSY,SEAT FRAME,310,SAPPHIRE BLUE	2.16
CW310SA3-211	ASSY, HANDLE, 310,SKY WHITE	3.01
CW310SA3-221	ASSY, HANDLE, 310,BLACK	3.02
CW310SA3-231	ASSY, HANDLE, 310,RED	3.03
CW310SA3-241	ASSY, HANDLE, 310,PLAT SPKLE	3.04
CW310SA3-251	ASSY, HANDLE, 310,SILVER	3.05
CW310SA3-261	CW310SA3ASSY, HANDLE, 310,BLUE	3.06
CW310SA3-271	ASSY, HANDLE, 310,CHARCOAL	3.07
CW310SA3-281	ASSY, HANDLE, 310,CATH GRY	3.08
CW310SA3-291	ASSY, HANDLE, 310,SILVER VIEN	3.09
CW310SA3-311	ASSY, HANDLE, 310,STONE HG	3.11
CW310SA3-321	ASSY, HANDLE, 310,TITANIUM HG	3.12
CW310SA3-331	ASSY, HANDLE, 310,WHITE GLOSS	3.13
CW310SA3-341	ASSY, HANDLE, 310,BLACK ONYX	3.14
CW310SA3-351	ASSY, HANDLE, 310,LIGHT BRONZE	3.15

CW310SA3-361	ASSY, HANDLE, 310,SAPPHIRE BLUE	3.16
CW310SA4-211	ASSY,LOWER STRUT, 310,SKY WHITE	4.01
CW310SA4-221	ASSY,LOWER STRUT, 310,BLACK	4.02
CW310SA4-231	ASSY,LOWER STRUT, 310,RED	4.03
CW310SA4-241	ASSY,LOWER STRUT, 310,PLATINUM SPAR	4.04
CW310SA4-251	ASSY,LOWER STRUT, 310,SILVER	4.05
CW310SA4-261	ASSY,LOWER STRUT, 310,BLUE	4.06
CW310SA4-271	ASSY,LOWER STRUT, 310,CHARCOAL	4.07
CW310SA4-281	ASSY,LOWER STRUT, 310,CATHEDRAL GRA	4.08
CW310SA4-311	ASSY,LOWER STRUT, 310,STONE HG	4.11
CW310SA4-321	ASSY,LOWER STRUT, 310,TITANIUM HG	4.12
CW310SA4-331	ASSY,LOWER STRUT, 310,WHITE GLOSS	4.13
CW310SA4-341	ASSY,LOWER STRUT, 310,BLACK ONYX	4.14
CW310SA4-351	ASSY,LOWER STRUT, 310,LIGHT BRONZE	4.15
CW310SA4-361	ASSY,LOWER STRUT, 310,SAPPHIRE BLUE	4.16
CW310SA6-211	ASSY,UPPER STRUT, 310,SKY WHITE	5.01
CW310SA6-221	ASSY,UPPER STRUT, 310,BLACK	5.02
CW310SA6-231	ASSY,UPPER STRUT, 310,RED	5.03
CW310SA6-241	ASSY,UPPER STRUT, 310,PLATINUM SPAR	5.04
CW310SA6-251	ASSY,UPPER STRUT, 310,SILVER	5.05
CW310SA6-261	ASSY,UPPER STRUT, 310,BLUE	5.06
CW310SA6-271	ASSY,UPPER STRUT, 310,CHARCOAL	5.07
CW310SA6-281	ASSY,UPPER STRUT, 310,CATHEDRAL GRA	5.08
CW310SA6-291	ASSY,UPPER STRUT, 310,SILVER VEIN	5.09
CW310SA6-311	ASSY,UPPER STRUT, 310,STONE HG	5.11
CW310SA6-321	ASSY,UPPER STRUT, 310,TITANIUM HG	5.12
CW310SA6-331	ASSY,UPPER STRUT, 310,WHITE GLOSS	5.13
CW310SA6-341	ASSY,UPPER STRUT, 310,BLACK ONYX	5.14
CW310SA6-351	ASSY,UPPER STRUT, 310,LIGHT BRONZE	5.15
CW310SA6-361	ASSY,UPPER STRUT, 310,SAPPHIRE BLUE	5.16
CWAC1009-101	PULLEY, 4 1/2 DIA. X 1/2 ID	9
CW12406-101	PILLOW BLOCK, BEARING, 2 BOLT	10
CW12404-101	CAP, GUIDE ROD,DIA 3/4, BLK	11
CW30165-751	ASSY, POP PIN, 0.450 DIA HANDLE, B	12
CW11396-101	WHEEL, NEOPRENE RUBBER W/ BEARINGS	13
CW12402-101	BUMPER, WEIGHT STACK, BLK RUBBER	14
CWGR2505-000	GRIP,RUBBER,3/4" DIA, 5"	18
CWGR2620-000	GRIP,RUBBER, 1" DIA, 20"	19
CWAC1228-901	SPACER, ALU,.328 ID X .625 OD X .25	20
CWAC1236-102	GUIDE INSERT, PLASTIC WITH HOLE, BL	22
CWAC1236-101	GUIDE INSERT, PLASTIC WITHOUT HOLE,	23
CWAC218-901	HANDLE END CAP W/SET SCREWS, DIA 1"	24
CWAC220-901	HANDLE END CAP W/SET SCREWS, DIA 3/	25
CWPF1212-711	GUIDE ROD, 3/4 X 42 5/8 (#4), CHM	26
CW30288-711	ASSY,SEAT ADJUST,20 DEGREE, 8 HOLE,	27
CW32212-711	ASSEMBLY, SEATPAD ADJUSTMENT, 8 HO	27
CW31038-711	ASSY, SEAT ADJUSTMENT, ANGLED, 8 HO	28
CW32213-711	ASSEMBLY, CHEST ADJUSTMENT, ANGLE	28
CW30014-105	CUT PIECE, CREPE, 7/16 X 2 X 4	29
CW30014-103	CUT PIECE, CREPE, 7/16 X 2 X 2	30
CW30012-104	CUT PIECE, ABS BLACK, 1/8 X 1 3/4 X	31
CW30013-102	CUT PIECE, CREPE, 1/4 X 2 1/2 X 6 1	32

CWCLGP127-125	ASSY, CABLE, 310	33
CWPD1207B-101	PAD,5X9X14.5,4HOLES,W/BP,BLACK	34.01
CWPD1207B-102	PAD,5X9X14.5,4HOLES,W/BP,RYL BL	34.02
CWPD1207B-103	PAD,5X9X14.5,4HOLES,W/BP,DVE GRY	34.03
CWPD1207B-104	PAD,5X9X14.5,4HOLES,W/BP,CROCUS	34.04
CWPD1207B-105	PAD,5X9X14.5,4HOLES,W/BP,GROTTO	34.05
CWPD1207B-106	PAD,5X9X14.5,4HOLES,W/BP,GRAPHITE	34.06
CWPD1207B-107	PAD,5X9X14.5,4HOLES,W/BP,RED	34.07
CWPD1207B-108	PAD,5X9X14.5,4HOLES,W/BP,CHN GRN	34.08
CWPD1207B-109	PAD,5X9X14.5,4HOLES,W/BP,TURQSE	34.09
CWPD1207B-110	PAD,5X9X14.5,4HOLES,W/BP,RASP	34.1
CWPD1207B-111	PAD,5X9X14.5,4HOLES,W/BP,PLUM	34.11
CWPD1207B-112	PAD,5X9X14.5,4HOLES,W/BP,REGIMENT	34.12
CWPD1207B-113	PAD,5X9X14.5,4HOLES,W/BP,SPC BLUE	34.13
CWPD1207B-115	PAD,5X9X14.5,4HOLES,W/BP,BLK LTHR	34.15
CWPD1207B-116	PAD,5X9X14.5,4HOLES,W/BP,NVBL LTH	34.16
CWPD1207B-117	PAD,5X9X14.5,4HOLES,W/BP,PUTTY	34.17
CWPD1207B-118	PAD,5X9X14.5,4HOLES,W/BP,IMPRL BL	34.18
CWPD1207B-119	PAD,5X9X14.5,4HOLES,W/BP,YEW GRN	34.19
CWPD1207B-120	PAD,5X9X14.5,4HOLES,W/BP,DSTY JD	34.2
CWPD1207B-121	PAD,5X9X14.5,4HOLES,W/BP,TER COT	34.21
CWPD1207B-122	PAD,5X9X14.5,4HOLES,W/BP,PAPRIKA	34.22
CWPD1207B-123	PAD,5X9X14.5,4HLS,W/BP,ASH LTHR	34.23
CWPD1207B-124	PAD,5X9X14.5,4HLS,W/BP,CERULAN LTHR	34.24
CWPD1207B-125	PAD,5X9X14.5,4HLS,W/BP,CHARCOAL LTH	34.25
CWPD1207B-126	PAD,5X9X14.5,4HLS,W/BP,HUNTER LTHR	34.26
CWPD1207B-127	PAD,5X9X14.5,4HLS,W/BP,MOSS LTHR	34.27
CWPD1207B-128	PAD,5X9X14.5,4HLS,W/BP,SPICE LTHR	34.28
CWPD1207B-129	PAD,5X9X14.5,4HLS,W/BP,TOMATO LTH	34.29
CWPD1209B-101	PAD,6.25X9X10,4HOLES,W/BP,BLACK	35.01
CWPD1209B-102	PAD,6.25X9X10,4HOLES,W/BP,RYL BL	35.02
CWPD1209B-103	PAD,6.25X9X10,4HOLES,W/BP,DVE GRY	35.03
CWPD1209B-104	PAD,6.25X9X10,4HOLES,W/BP,CROCUS	35.04
CWPD1209B-105	PAD,6.25X9X10,4HOLES,W/BP,GROTTO	35.05
CWPD1209B-106	PAD,6.25X9X10,4HOLES,W/BP,GRAPHITE	35.06
CWPD1209B-107	PAD,6.25X9X10,4HOLES,W/BP,RED	35.07
CWPD1209B-108	PAD,6.25X9X10,4HOLES,W/BP,CHN GRN	35.08
CWPD1209B-109	PAD,6.25X9X10,4HOLES,W/BP,TURQSE	35.09
CWPD1209B-110	PAD,6.25X9X10,4HOLES,W/BP,RASP	35.1
CWPD1209B-111	PAD,6.25X9X10,4HOLES,W/BP,PLUM	35.11
CWPD1209B-112	PAD,6.25X9X10,4HOLES,W/BP,REGIMENT	35.12
CWPD1209B-113	PAD,6.25X9X10,4HOLES,W/BP,SPC BLUE	35.13
CWPD1209B-115	PAD,6.25X9X10,4HOLES,W/BP,BLK LTHR	35.15
CWPD1209B-116	PAD,6.25X9X10,4HOLES,W/BP,NVBL LTH	35.16
CWPD1209B-117	PAD,6.25X9X10,4HOLES,W/BP,PUTTY	35.17
CWPD1209B-118	PAD,6.25X9X10,4HOLES,W/BP,IMPRL BL	35.18
CWPD1209B-119	PAD,6.25X9X10,4HOLES,W/BP,YEW GRN	35.19
CWPD1209B-120	PAD,6.25X9X10,4HOLES,W/BP,DSTY JD	35.2
CWPD1209B-121	PAD,6.25X9X10,4HOLES,W/BP,TER COT	35.21
CWPD1209B-122	PAD,6.25X9X10,4HOLES,W/BP,PAPRIKA	35.22
CWPD1209B-123	PAD,6.25X9X10,4HLS,W/BP,ASH LTHR	35.23
CWPD1209B-124	PAD,6.25X9X10,4HL,W/BP,CERULAN LTHR	35.24

CWPD1209B-125	PAD,6.25X9X10,4HL,W/BP,CHARCOAL LTH	35.25
CWPD1209B-126	PAD,6.25X9X10,4HLS,W/BP,HUNTER LTHR	35.26
CWPD1209B-127	PAD,6.25X9X10,4HLS,W/BP,MOSS LTHR	35.27
CWPD1209B-128	PAD,6.25X9X10,4HLS,W/BP,SPICE LTHR	35.28
CWPD1209B-129	PAD,6.25X9X10,4HLS,W/BP,TOMATO LTHR	35.29
CWHCYN050-100	SCREW,HEX HEAD,BLK XYLAN,1/2-13 X 1	38
CWHCYN050-200	SCREW, HEX HEAD, BLK XYLAN, 1/2-13	39
CWKADLN031-053	NUT, ACORN, 5/16-18	40
CWKADLN050-081	NUT, ACORN, 1/2-13	41
CW12537-109	NUT,INSERT,THIN-NUT,LARGE FLANGE	42
CWCLFA1064-741	ROD END, FEMALE, STEEL, ZINC, CAD,	43
CWTAYN031-200	SCREW, BUTTON HEAD, BLK XYLAN, 5/1	44
CWTAYN031-100	SCREW, BUTTON HEAD, BLK XYLAN, 5/1	45
CWTAYN031-150	SCREW, BUTTON HEAD, BLK XYLAN,5/16	46
CWCAYN038-100	SCREW, SOCKET HEAD, BLK XYLAN, 3/	47
CWBFNN050-250	STUD, 1/2-13 X 2 1/2	48
CWWBKN031-007	WASHER, FLAT, TYPE A, SAE, 5/16 ID	49
CWWBKN038-007	WASHER, FLAT, TYPE A, SAE, 3/8 ID	50
CWWBKN050-010	WASHER, FLAT, TYPE A, SAE, 1/2 ID X	51
CWWALYN031-008	WASHER, SPLIT, 5/16 ID, BL	52
CWWALYN038-009	WASHER, SPLIT, 3/8 ID, BLK XYLAN	53
CWWALYN050-013	WASHER, SPLIT, 1/2 ID, BLK XYLAN	54
CW30010-101	LABEL,WARNING STRENGTH	55
CW30141-101	ASSY, LABEL,INSTRUCTION,310	56
CW31756-101	LABEL, PRECOR USA ICARIAN LINE	57
CWPF4002-711	WELDMENT, SEAT ADJUST, 20 DEGREE, 8	70
CWAC220-901	HANDLE END CAP W/SET SCREWS, DIA 3/	71
CWGR2505-000	GRIP,RUBBER,3/4" DIA, 5"	72
CW12633-101	ENDCAP, REC TUBE, LDP, 1 1/2 X 3 1	75
CW10510-721	ASSY, PLATE, WEIGHT, 10 LBS, WRKL B	201
CW10520-721	ASSY, PLATE, WEIGHT, 20 LBS, WRKL B	202
CWAC1133-101	BUSHING, WEIGHT PLATE, LDPE PLASTIC	203
CW30173-751	ASSY, 6.00 IN WEIGHT STACK PIN AND	228
CWLDNN038-200	PIN, ROLL, DIA 3/8 X 2	250
CW30184-901	ASSY,BARREL,TOP PLATE,ALUMINUM	251
CW10550-721	PLATE, WEIGHT, MED TOP (MTP-S), 10	283
CW10550-722	PLATE, WEIGHT, MED TOP (MTP-S), 10	283
CW30131-711	SELECTOR STEM, 18 PLATE,0 .875 DIA,	306
CW30011-101	LABEL,WARNING WEIGHT STACK	311
CW12401-106	LABEL, WEIGHT PLATE, 20 LBS/ 8 KG	319
CW12401-110	LABEL, WEIGHT PLATE, 30 LBS/ 13.6 K	323
CW12401-114	LABEL, WEIGHT PLATE, 40 LBS/ 18.2 K	326
CW12401-114	LABEL, WEIGHT PLATE, 40 LBS/ 18.2 K	327
CW12401-118	LABEL, WEIGHT PLATE, 50 LBS/ 22.7 K	330
CW12401-118	LABEL, WEIGHT PLATE, 50 LBS/ 22.7 K	331
CW12401-120	LABEL, WEIGHT PLATE, 60 LBS/ 27.3 K	332
CW12401-120	LABEL, WEIGHT PLATE, 60 LBS/ 27.3 K	333
CW12401-122	LABEL, WEIGHT PLATE, 70 LBS/ 31.8 K	335
CW12401-124	LABEL, WEIGHT PLATE, 80 LBS/ 36.4 K	337
CW12401-126	LABEL, WEIGHT PLATE, 90 LBS/ 40.9 K	339
CW12401-128	LABEL, WEIGHT PLATE, 100 LBS/ 45.5	341
CW12401-130	LABEL, WEIGHT PLATE, 120 LBS/ 54.6	343

CW12401-132	LABEL, WEIGHT PLATE, 140 LBS/ 63.6	345
CW12401-134	LABEL, WEIGHT PLATE, 160 LBS/ 72.7	347
CW12401-136	LABEL, WEIGHT PLATE, 180 LBS/ 81.8	349
CW12401-138	LABEL, WEIGHT PLATE, 200 LBS/ 90.9	351
CW12401-140	LABEL, WEIGHT PLATE, 220 LBS/ 100 K	353
CW12401-142	LABEL, WEIGHT PLATE, 240 LBS/ 109.1	355
CW12401-144	LABEL, WEIGHT PLATE, 260 LBS/ 118.2	357
CW12401-145	LABEL, WEIGHT PLATE, 280 LBS/ 127.3	358
CW12401-146	LABEL, WEIGHT PLATE, 300 LBS/ 136.4	359
CW12537-109	NUT,INSERT,THIN-NUT,LARGE FLANGE	400
CW30126-101	LABEL,VINYL, PRECOR, 3.25 X 18.0	401
CWPF3143-211	SHROUD,SHEET,STEEL,3/32 THICK,4 BEN	402.01
CWPF3143-221	SHROUD,SHEET,STEEL,3/32 THICK,4 BEN	402.02
CWPF3143-231	SHROUD,SHEET,STEEL,3/32 THICK,4 BEN	402.03
CWPF3143-241	SHROUD,SHEET,STEEL,3/32 THICK,4 BEN	402.04
CWPF3143-251	SHROUD,SHEET,STEEL,3/32 THICK,4 BEN	402.05
CWPF3143-261	SHROUD,SHEET,STEEL,3/32 THICK,4 BEN	402.06
CWPF3143-271	SHROUD,SHEET,STEEL,3/32 THICK,4 BEN	402.07
CWPF3143-281	SHROUD,SHEET,STEEL,3/32 THICK,4 BEN	402.08
CWPF3143-291	SHROUD,SHEET,STEEL,3/32 THICK,4 BEN	402.09
CWPF3143-311	SHROUD,SHEET,STEEL,3/32 THICK,4 BEN	402.11
CWPF3143-321	SHROUD,SHEET,STEEL,3/32 THICK,4 BEN	402.12
CWPF3143-331	SHROUD,SHEET,STEEL,3/32 THICK,4 BEN	402.13
CWPF3143-341	SHROUD,SHEET,STEEL,3/32 THICK,4 BEN	402.14
CWPF3143-351	SHROUD,SHEET,STEEL,3/32 THICK,4 BEN	402.15
CWPF3143-361	SHROUD,SHEET,STEEL,3/32 THICK,4 BEN	402.16
CWPF3143-711	SHROUD,SHEET,STEEL,3/32 THICK,4 BEN	402.17
CWPF3144-721	SHROUD BRKT,PLATE,STEEL,1/8 THICK,1	403
CWPF3145-721	SHROUD BRKT,PLATE,STEEL,1/8 THICK,2	404
CWTAYN031-100	SCREW, BUTTON HEAD, BLK XYLAN, 5/1	405
CWWALYN031-008	WASHER, SPLIT, 5/16 ID, BL	406
CWWBKN031-007	WASHER, FLAT, TYPE A, SAE, 5/16 ID	407
CWAC1177-101	FLOOR PROTECTOR, RUBBER, 4.563 X 4.	501
CWAC1179-101	FLOOR PROTECTOR, RUBBER, 4.813 X 2.	502
CWAC1181-101	FLOOR PROTECTOR, RUBBER, 4.563 X 4.	503

**310 Seated Row**

<b>Part Number</b>	<b>Description</b>	<b>Bubble Number</b>
CW310SA1-211	ASSY,FRAME,MAIN,310,SKY WHITE	1.01
CW310SA1-221	ASSY,FRAME,MAIN,310,BLACK	1.02
CW310SA1-231	ASSY,FRAME,MAIN,310,RED	1.03
CW310SA1-241	ASSY,FRAME,MAIN,310,PLATINUM SPRKLE	1.04
CW310SA1-251	ASSY,FRAME,MAIN,310,SILVER	1.05
CW310SA1-261	ASSY,FRAME,MAIN,310,BLUE	1.06
CW310SA1-271	ASSY,FRAME,MAIN,310,CHARCOAL	1.07
CW310SA1-281	ASSY,FRAME,MAIN,310,CATHEDRAL GRAY	1.08
CW310SA1-291	ASSY,FRAME,MAIN,310,SILVER VIEN	1.09
CW310SA1-311	ASSY,FRAME,MAIN,310,STONE HG	1.11
CW310SA1-321	ASSY,FRAME,MAIN,310,TITANIUM HG	1.12
CW310SA1-331	ASSY,FRAME,MAIN,310,WHITE GLOSS	1.13
CW310SA1-341	ASSY,FRAME,MAIN,310,BLACK ONYX	1.14
CW310SA1-351	ASSY,FRAME,MAIN,310,LIGHT BRONZE	1.15
CW310SA1-361	ASSY,FRAME,MAIN,310,SAPPHIRE BLUE	1.16
CW310SA2-211	ASSY,SEAT FRAME,310,SKY WHITE	2.01
CW310SA2-212	ASSY,SEAT FRAME,310,SKY WHITE	2.01
CW310SA2-221	ASSY,SEAT FRAME,310,BLACK	2.02
CW310SA2-222	ASSY,SEAT FRAME,310,BLACK	2.02
CW310SA2-231	ASSY,SEAT FRAME,310,RED	2.03
CW310SA2-241	ASSY,SEAT FRAME,310,PLATINUM SPARKL	2.04
CW310SA2-251	ASSY,SEAT FRAME,310,SILVER	2.05
CW310SA2-261	ASSY,SEAT FRAME,310,BLUE	2.06
CW310SA2-271	ASSY,SEAT FRAME,310,CHARCOAL	2.07
CW310SA2-281	ASSY,SEAT FRAME,310,CATHEDRAL GRAY	2.08
CW310SA2-291	ASSY,SEAT FRAME,310,SILVER VEIN	2.09
CW310SA2-311	ASSY,SEAT FRAME,310,STONE HG	2.11
CW310SA2-312	ASSY,SEAT FRAME,310,STONE HG	2.11
CW310SA2-321	ASSY,SEAT FRAME,310,TITANIUM HG	2.12
CW310SA2-322	ASSY,SEAT FRAME,310,TITANIUM HG	2.12
CW310SA2-331	ASSY,SEAT FRAME,310,WHITE GLOSS	2.13
CW310SA2-341	ASSY,SEAT FRAME,310,BLACK ONYX	2.14
CW310SA2-351	ASSY,SEAT FRAME,310,LIGHT BRONZE	2.15
CW310SA2-352	ASSY,SEAT FRAME,310,LIGHT BRONZE	2.15
CW310SA2-361	ASSY,SEAT FRAME,310,SAPPHIRE BLUE	2.16
CW310SA2-362	ASSY,SEAT FRAME,310,SAPPHIRE BLUE	2.16
CW310SA3-211	ASSY, HANDLE, 310,SKY WHITE	3.01
CW310SA3-221	ASSY, HANDLE, 310,BLACK	3.02
CW310SA3-231	ASSY, HANDLE, 310,RED	3.03
CW310SA3-241	ASSY, HANDLE, 310,PLAT SPKLE	3.04
CW310SA3-251	ASSY, HANDLE, 310,SILVER	3.05
CW310SA3-261	CW310SA3ASSY, HANDLE, 310,BLUE	3.06
CW310SA3-271	ASSY, HANDLE, 310,CHARCOAL	3.07
CW310SA3-281	ASSY, HANDLE, 310,CATH GRY	3.08
CW310SA3-291	ASSY, HANDLE, 310,SILVER VIEN	3.09
CW310SA3-311	ASSY, HANDLE, 310,STONE HG	3.11
CW310SA3-321	ASSY, HANDLE, 310,TITANIUM HG	3.12
CW310SA3-331	ASSY, HANDLE, 310,WHITE GLOSS	3.13
CW310SA3-341	ASSY, HANDLE, 310,BLACK ONYX	3.14
CW310SA3-351	ASSY, HANDLE, 310,LIGHT BRONZE	3.15

CW310SA3-361	ASSY, HANDLE, 310,SAPPHIRE BLUE	3.16
CW310SA4-211	ASSY,LOWER STRUT, 310,SKY WHITE	4.01
CW310SA4-221	ASSY,LOWER STRUT, 310,BLACK	4.02
CW310SA4-231	ASSY,LOWER STRUT, 310,RED	4.03
CW310SA4-241	ASSY,LOWER STRUT, 310,PLATINUM SPAR	4.04
CW310SA4-251	ASSY,LOWER STRUT, 310,SILVER	4.05
CW310SA4-261	ASSY,LOWER STRUT, 310,BLUE	4.06
CW310SA4-271	ASSY,LOWER STRUT, 310,CHARCOAL	4.07
CW310SA4-281	ASSY,LOWER STRUT, 310,CATHEDRAL GRA	4.08
CW310SA4-311	ASSY,LOWER STRUT, 310,STONE HG	4.11
CW310SA4-321	ASSY,LOWER STRUT, 310,TITANIUM HG	4.12
CW310SA4-331	ASSY,LOWER STRUT, 310,WHITE GLOSS	4.13
CW310SA4-341	ASSY,LOWER STRUT, 310,BLACK ONYX	4.14
CW310SA4-351	ASSY,LOWER STRUT, 310,LIGHT BRONZE	4.15
CW310SA4-361	ASSY,LOWER STRUT, 310,SAPPHIRE BLUE	4.16
CW310SA6-211	ASSY,UPPER STRUT, 310,SKY WHITE	5.01
CW310SA6-221	ASSY,UPPER STRUT, 310,BLACK	5.02
CW310SA6-231	ASSY,UPPER STRUT, 310,RED	5.03
CW310SA6-241	ASSY,UPPER STRUT, 310,PLATINUM SPAR	5.04
CW310SA6-251	ASSY,UPPER STRUT, 310,SILVER	5.05
CW310SA6-261	ASSY,UPPER STRUT, 310,BLUE	5.06
CW310SA6-271	ASSY,UPPER STRUT, 310,CHARCOAL	5.07
CW310SA6-281	ASSY,UPPER STRUT, 310,CATHEDRAL GRA	5.08
CW310SA6-291	ASSY,UPPER STRUT, 310,SILVER VEIN	5.09
CW310SA6-311	ASSY,UPPER STRUT, 310,STONE HG	5.11
CW310SA6-321	ASSY,UPPER STRUT, 310,TITANIUM HG	5.12
CW310SA6-331	ASSY,UPPER STRUT, 310,WHITE GLOSS	5.13
CW310SA6-341	ASSY,UPPER STRUT, 310,BLACK ONYX	5.14
CW310SA6-351	ASSY,UPPER STRUT, 310,LIGHT BRONZE	5.15
CW310SA6-361	ASSY,UPPER STRUT, 310,SAPPHIRE BLUE	5.16
CWAC1009-101	PULLEY, 4 1/2 DIA. X 1/2 ID	9
CW12406-101	PILLOW BLOCK, BEARING, 2 BOLT	10
CW12404-101	CAP, GUIDE ROD,DIA 3/4, BLK	11
CW30165-751	ASSY, POP PIN, 0.450 DIA HANDLE, B	12
CW11396-101	WHEEL, NEOPRENE RUBBER W/ BEARINGS	13
CW12402-101	BUMPER, WEIGHT STACK, BLK RUBBER	14
CWGR2505-000	GRIP,RUBBER,3/4" DIA, 5"	18
CWGR2620-000	GRIP,RUBBER, 1" DIA, 20"	19
CWAC1228-901	SPACER, ALU,.328 ID X .625 OD X .25	20
CWAC1236-102	GUIDE INSERT, PLASTIC WITH HOLE, BL	22
CWAC1236-101	GUIDE INSERT, PLASTIC WITHOUT HOLE,	23
CWAC218-901	HANDLE END CAP W/SET SCREWS, DIA 1"	24
CWAC220-901	HANDLE END CAP W/SET SCREWS, DIA 3/	25
CWPF1212-711	GUIDE ROD, 3/4 X 42 5/8 (#4), CHM	26
CW30288-711	ASSY,SEAT ADJUST,20 DEGREE, 8 HOLE,	27
CW32212-711	ASSEMBLY, SEATPAD ADJUSTMENT, 8 HO	27
CW31038-711	ASSY, SEAT ADJUSTMENT, ANGLED, 8 HO	28
CW32213-711	ASSEMBLY, CHEST ADJUSTMENT, ANGLE	28
CW30014-105	CUT PIECE, CREPE, 7/16 X 2 X 4	29
CW30014-103	CUT PIECE, CREPE, 7/16 X 2 X 2	30
CW30012-104	CUT PIECE, ABS BLACK, 1/8 X 1 3/4 X	31
CW30013-102	CUT PIECE, CREPE, 1/4 X 2 1/2 X 6 1	32



CWCLGP127-125	ASSY, CABLE, 310	33
CWPD1207B-101	PAD,5X9X14.5,4HOLES,W/BP,BLACK	34.01
CWPD1207B-102	PAD,5X9X14.5,4HOLES,W/BP,RYL BL	34.02
CWPD1207B-103	PAD,5X9X14.5,4HOLES,W/BP,DVE GRY	34.03
CWPD1207B-104	PAD,5X9X14.5,4HOLES,W/BP,CROCUS	34.04
CWPD1207B-105	PAD,5X9X14.5,4HOLES,W/BP,GROTTO	34.05
CWPD1207B-106	PAD,5X9X14.5,4HOLES,W/BP,GRAPHITE	34.06
CWPD1207B-107	PAD,5X9X14.5,4HOLES,W/BP,RED	34.07
CWPD1207B-108	PAD,5X9X14.5,4HOLES,W/BP,CHN GRN	34.08
CWPD1207B-109	PAD,5X9X14.5,4HOLES,W/BP,TURQSE	34.09
CWPD1207B-110	PAD,5X9X14.5,4HOLES,W/BP,RASP	34.1
CWPD1207B-111	PAD,5X9X14.5,4HOLES,W/BP,PLUM	34.11
CWPD1207B-112	PAD,5X9X14.5,4HOLES,W/BP,REGIMENT	34.12
CWPD1207B-113	PAD,5X9X14.5,4HOLES,W/BP,SPC BLUE	34.13
CWPD1207B-115	PAD,5X9X14.5,4HOLES,W/BP,BLK LTHR	34.15
CWPD1207B-116	PAD,5X9X14.5,4HOLES,W/BP,NVBL LTH	34.16
CWPD1207B-117	PAD,5X9X14.5,4HOLES,W/BP,PUTTY	34.17
CWPD1207B-118	PAD,5X9X14.5,4HOLES,W/BP,IMPRL BL	34.18
CWPD1207B-119	PAD,5X9X14.5,4HOLES,W/BP,YEW GRN	34.19
CWPD1207B-120	PAD,5X9X14.5,4HOLES,W/BP,DSTY JD	34.2
CWPD1207B-121	PAD,5X9X14.5,4HOLES,W/BP,TER COT	34.21
CWPD1207B-122	PAD,5X9X14.5,4HOLES,W/BP,PAPRIKA	34.22
CWPD1207B-123	PAD,5X9X14.5,4HLS,W/BP,ASH LTHR	34.23
CWPD1207B-124	PAD,5X9X14.5,4HLS,W/BP,CERULAN LTHR	34.24
CWPD1207B-125	PAD,5X9X14.5,4HLS,W/BP,CHARCOAL LTH	34.25
CWPD1207B-126	PAD,5X9X14.5,4HLS,W/BP,HUNTER LTHR	34.26
CWPD1207B-127	PAD,5X9X14.5,4HLS,W/BP,MOSS LTHR	34.27
CWPD1207B-128	PAD,5X9X14.5,4HLS,W/BP,SPICE LTHR	34.28
CWPD1207B-129	PAD,5X9X14.5,4HLS,W/BP,TOMATO LTH	34.29
CWPD1209B-101	PAD,6.25X9X10,4HOLES,W/BP,BLACK	35.01
CWPD1209B-102	PAD,6.25X9X10,4HOLES,W/BP,RYL BL	35.02
CWPD1209B-103	PAD,6.25X9X10,4HOLES,W/BP,DVE GRY	35.03
CWPD1209B-104	PAD,6.25X9X10,4HOLES,W/BP,CROCUS	35.04
CWPD1209B-105	PAD,6.25X9X10,4HOLES,W/BP,GROTTO	35.05
CWPD1209B-106	PAD,6.25X9X10,4HOLES,W/BP,GRAPHITE	35.06
CWPD1209B-107	PAD,6.25X9X10,4HOLES,W/BP,RED	35.07
CWPD1209B-108	PAD,6.25X9X10,4HOLES,W/BP,CHN GRN	35.08
CWPD1209B-109	PAD,6.25X9X10,4HOLES,W/BP,TURQSE	35.09
CWPD1209B-110	PAD,6.25X9X10,4HOLES,W/BP,RASP	35.1
CWPD1209B-111	PAD,6.25X9X10,4HOLES,W/BP,PLUM	35.11
CWPD1209B-112	PAD,6.25X9X10,4HOLES,W/BP,REGIMENT	35.12
CWPD1209B-113	PAD,6.25X9X10,4HOLES,W/BP,SPC BLUE	35.13
CWPD1209B-115	PAD,6.25X9X10,4HOLES,W/BP,BLK LTHR	35.15
CWPD1209B-116	PAD,6.25X9X10,4HOLES,W/BP,NVBL LTH	35.16
CWPD1209B-117	PAD,6.25X9X10,4HOLES,W/BP,PUTTY	35.17
CWPD1209B-118	PAD,6.25X9X10,4HOLES,W/BP,IMPRL BL	35.18
CWPD1209B-119	PAD,6.25X9X10,4HOLES,W/BP,YEW GRN	35.19
CWPD1209B-120	PAD,6.25X9X10,4HOLES,W/BP,DSTY JD	35.2
CWPD1209B-121	PAD,6.25X9X10,4HOLES,W/BP,TER COT	35.21
CWPD1209B-122	PAD,6.25X9X10,4HOLES,W/BP,PAPRIKA	35.22
CWPD1209B-123	PAD,6.25X9X10,4HLS,W/BP,ASH LTHR	35.23
CWPD1209B-124	PAD,6.25X9X10,4HL,W/BP,CERULAN LTHR	35.24

CWPD1209B-125	PAD,6.25X9X10,4HL,W/BP,CHARCOAL LTH	35.25
CWPD1209B-126	PAD,6.25X9X10,4HLS,W/BP,HUNTER LTHR	35.26
CWPD1209B-127	PAD,6.25X9X10,4HLS,W/BP,MOSS LTHR	35.27
CWPD1209B-128	PAD,6.25X9X10,4HLS,W/BP,SPICE LTHR	35.28
CWPD1209B-129	PAD,6.25X9X10,4HLS,W/BP,TOMATO LTHR	35.29
CWHCYN050-100	SCREW,HEX HEAD,BLK XYLAN,1/2-13 X 1	38
CWHCYN050-200	SCREW, HEX HEAD, BLK XYLAN, 1/2-13	39
CWKADLN031-053	NUT, ACORN, 5/16-18	40
CWKADLN050-081	NUT, ACORN, 1/2-13	41
CW12537-109	NUT,INSERT,THIN-NUT,LARGE FLANGE	42
CWCLFA1064-741	ROD END, FEMALE, STEEL, ZINC, CAD,	43
CWTAYN031-200	SCREW, BUTTON HEAD, BLK XYLAN, 5/1	44
CWTAYN031-100	SCREW, BUTTON HEAD, BLK XYLAN, 5/1	45
CWTAYN031-150	SCREW, BUTTON HEAD, BLK XYLAN,5/16	46
CWCAYN038-100	SCREW, SOCKET HEAD, BLK XYLAN, 3/	47
CWBFNN050-250	STUD, 1/2-13 X 2 1/2	48
CWWBKN031-007	WASHER, FLAT, TYPE A, SAE, 5/16 ID	49
CWWBKN038-007	WASHER, FLAT, TYPE A, SAE, 3/8 ID	50
CWWBKN050-010	WASHER, FLAT, TYPE A, SAE, 1/2 ID X	51
CWWALYN031-008	WASHER, SPLIT, 5/16 ID, BL	52
CWWALYN038-009	WASHER, SPLIT, 3/8 ID, BLK XYLAN	53
CWWALYN050-013	WASHER, SPLIT, 1/2 ID, BLK XYLAN	54
CW30010-101	LABEL,WARNING STRENGTH	55
CW30141-101	ASSY, LABEL,INSTRUCTION,310	56
CW31756-101	LABEL, PRECOR USA ICARIAN LINE	57
CWPF4002-711	WELDMENT, SEAT ADJUST, 20 DEGREE, 8	70
CWAC220-901	HANDLE END CAP W/SET SCREWS, DIA 3/	71
CWGR2505-000	GRIP,RUBBER,3/4" DIA, 5"	72
CW12633-101	ENDCAP, REC TUBE, LDP, 1 1/2 X 3 1	75
CW10510-721	ASSY, PLATE, WEIGHT, 10 LBS, WRKL B	201
CW10520-721	ASSY, PLATE, WEIGHT, 20 LBS, WRKL B	202
CWAC1133-101	BUSHING, WEIGHT PLATE, LDPE PLASTIC	203
CW30173-751	ASSY, 6.00 IN WEIGHT STACK PIN AND	228
CWLDNN038-200	PIN, ROLL, DIA 3/8 X 2	250
CW30184-901	ASSY,BARREL, TOP PLATE,ALUMINUM	251
CW10550-721	PLATE, WEIGHT, MED TOP (MTP-S), 10	283
CW10550-722	PLATE, WEIGHT, MED TOP (MTP-S), 10	283
CW30131-711	SELECTOR STEM, 18 PLATE,0 .875 DIA,	306
CW30011-101	LABEL,WARNING WEIGHT STACK	311
CW12401-106	LABEL, WEIGHT PLATE, 20 LBS/ 8 KG	319
CW12401-110	LABEL, WEIGHT PLATE, 30 LBS/ 13.6 K	323
CW12401-114	LABEL, WEIGHT PLATE, 40 LBS/ 18.2 K	326
CW12401-114	LABEL, WEIGHT PLATE, 40 LBS/ 18.2 K	327
CW12401-118	LABEL, WEIGHT PLATE, 50 LBS/ 22.7 K	330
CW12401-118	LABEL, WEIGHT PLATE, 50 LBS/ 22.7 K	331
CW12401-120	LABEL, WEIGHT PLATE, 60 LBS/ 27.3 K	332
CW12401-120	LABEL, WEIGHT PLATE, 60 LBS/ 27.3 K	333
CW12401-122	LABEL, WEIGHT PLATE, 70 LBS/ 31.8 K	335
CW12401-124	LABEL, WEIGHT PLATE, 80 LBS/ 36.4 K	337
CW12401-126	LABEL, WEIGHT PLATE, 90 LBS/ 40.9 K	339
CW12401-128	LABEL, WEIGHT PLATE, 100 LBS/ 45.5	341
CW12401-130	LABEL, WEIGHT PLATE, 120 LBS/ 54.6	343

CW12401-132	LABEL, WEIGHT PLATE, 140 LBS/ 63.6	345
CW12401-134	LABEL, WEIGHT PLATE, 160 LBS/ 72.7	347
CW12401-136	LABEL, WEIGHT PLATE, 180 LBS/ 81.8	349
CW12401-138	LABEL, WEIGHT PLATE, 200 LBS/ 90.9	351
CW12401-140	LABEL, WEIGHT PLATE, 220 LBS/ 100 K	353
CW12401-142	LABEL, WEIGHT PLATE, 240 LBS/ 109.1	355
CW12401-144	LABEL, WEIGHT PLATE, 260 LBS/ 118.2	357
CW12401-145	LABEL, WEIGHT PLATE, 280 LBS/ 127.3	358
CW12401-146	LABEL, WEIGHT PLATE, 300 LBS/ 136.4	359
CW12537-109	NUT,INSERT,THIN-NUT,LARGE FLANGE	400
CW30126-101	LABEL,VINYL, PRECOR, 3.25 X 18.0	401
CWPF3143-211	SHROUD,SHEET,STEEL,3/32 THICK,4 BEN	402.01
CWPF3143-221	SHROUD,SHEET,STEEL,3/32 THICK,4 BEN	402.02
CWPF3143-231	SHROUD,SHEET,STEEL,3/32 THICK,4 BEN	402.03
CWPF3143-241	SHROUD,SHEET,STEEL,3/32 THICK,4 BEN	402.04
CWPF3143-251	SHROUD,SHEET,STEEL,3/32 THICK,4 BEN	402.05
CWPF3143-261	SHROUD,SHEET,STEEL,3/32 THICK,4 BEN	402.06
CWPF3143-271	SHROUD,SHEET,STEEL,3/32 THICK,4 BEN	402.07
CWPF3143-281	SHROUD,SHEET,STEEL,3/32 THICK,4 BEN	402.08
CWPF3143-291	SHROUD,SHEET,STEEL,3/32 THICK,4 BEN	402.09
CWPF3143-311	SHROUD,SHEET,STEEL,3/32 THICK,4 BEN	402.11
CWPF3143-321	SHROUD,SHEET,STEEL,3/32 THICK,4 BEN	402.12
CWPF3143-331	SHROUD,SHEET,STEEL,3/32 THICK,4 BEN	402.13
CWPF3143-341	SHROUD,SHEET,STEEL,3/32 THICK,4 BEN	402.14
CWPF3143-351	SHROUD,SHEET,STEEL,3/32 THICK,4 BEN	402.15
CWPF3143-361	SHROUD,SHEET,STEEL,3/32 THICK,4 BEN	402.16
CWPF3143-711	SHROUD,SHEET,STEEL,3/32 THICK,4 BEN	402.17
CWPF3144-721	SHROUD BRKT,PLATE,STEEL,1/8 THICK,1	403
CWPF3145-721	SHROUD BRKT,PLATE,STEEL,1/8 THICK,2	404
CWTAYN031-100	SCREW, BUTTON HEAD, BLK XYLAN, 5/1	405
CWWALYN031-008	WASHER, SPLIT, 5/16 ID, BL	406
CWWBKN031-007	WASHER, FLAT, TYPE A, SAE, 5/16 ID	407
CWAC1177-101	FLOOR PROTECTOR, RUBBER, 4.563 X 4.	501
CWAC1179-101	FLOOR PROTECTOR, RUBBER, 4.813 X 2.	502
CWAC1181-101	FLOOR PROTECTOR, RUBBER, 4.563 X 4.	503